

# GATEWAY

## Elementary School



### Take Care of Each Other

Gateway Elementary School

507 5<sup>th</sup> Avenue West

Meadow Lake, SK S9X 1A9

Telephone 306.236.4141

Fax 306.236.4471

[www.nwsd.ca/schools/gateway](http://www.nwsd.ca/schools/gateway)

Mr. R. Nordby  
Principal

Mr. G. Ackerman  
Vice-Principal

# Principal's Message

Welcome to Gateway Elementary School. Our motto here at Gateway is "Take Care of Each Other". What a simple solution to every problem we have on the face of the earth. I can't think of any problem we couldn't overcome if we all practiced this simple motto.

Gateway is an exciting school and provides a great opportunity for students to come and enjoy their education. The students actually have fun at Gateway because we try to keep this motto active and alive.

At Gateway we take a different approach to discipline in that we try to be like parents as well as educators. There are several rules that may seem unfair to the students, such as not allowing them to go to the local stores at lunchtime. This rule, like every other Gateway rule, is for the benefit of the students. The teachers extend this parenting approach by sticking our noses into what our students do after hours. Some parents are quite surprised when their child receives a consequence for an action that took place outside of school and off the property, but once our philosophy is explained, they are generally quite impressed with our methods and like the approach we take.

There aren't a lot of rules at Gateway. We believe that if we follow the Gateway motto there will be very little need for a long list of Do's and Don'ts.

Our teachers are good listeners and are willing to help you with any concerns you have inside, or outside of Gateway. We believe that coming to Gateway School should be an enjoyable experience for everyone. If you find that you are not enjoying yourself, you should seek out a teacher that you feel comfortable talking with. Once you have done this you will have taken the first step towards making your stay at Gateway a wonderful experience.

Mr. R. Nordby  
Principal

# Gateway Elementary School Staff

Mr. R. Nordby	Principal
Mr. G. Ackerman	Vice Principal
Mrs. L. Jaman	School Administrative Assistant
Mrs. J. Hadland	Resource
Mr. J. Gibson	Band
Mrs. D. Hill	Cree
Ms. P. Lumley	Library/Technology/Grade 6G
Ms. C. Mitchell	Literacy/Grade 5C
Mrs. L. Johnstone	Grade 5/6 French
Mrs. W. Craig	Addictions Counselor
Mrs. D. Pylot	Grade 5A
Ms. A. Henderson/	
Mrs. C. Hildebrand	Grade 5B
Mrs. S. Plant	Grade 5C
Mr. G. Whittle/	
Mrs. M. Gerwing	Grade 5D
Mrs. G. Osborne	Grade 5E
Ms. J. Wilson	Grade 6A
Mrs. A. Ellis	Grade 6B
Mr. T. Mutch	Grade 6C
Mrs. A. East	Grade 6D
Mrs. L. Buffin	Grade 6E
Mrs. A. Fry	Grade 6F
Ms. M. Carr	Grade 6G
Mrs. J. Follett	Community School Coordinator
Mr. J. Mielke	Activities Coordinator
Mrs. S. Boomer	Student Services Provider
Ms. K. Lariviere	Student Services
Ms. T. Richards	Library Technician
Mrs. A. Wall	Educational Assistant
Mrs. J. McLaughlin	Educational Assistant
Mrs. J. Barker	Educational Assistant
Mr. R. Kessler	Custodian

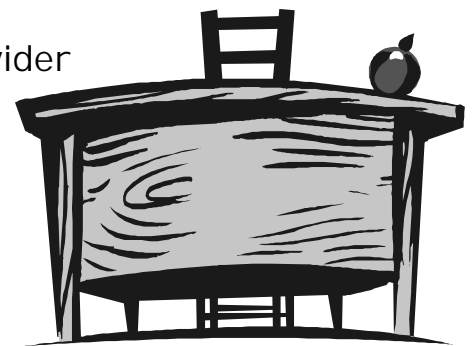

# Northwest School Division #203

Schools of the Northwest School Division are found in communities in Saskatchewan from Pierceland to Dorintosh in the north and south to Marsden and Edam. Approximately 5300 students attend the 24 schools in the division and are offered a wide variety of highly successful academic and extra-curricular programs. We are proud of the public education systems in the Northwest and look forward to carrying forward the standards of excellence into the new organization.

The goals of education recognize the inherent worth and value of each individual. Education should develop the potential of each student to the fullest extent. However, to achieve these goals, education must be the shared responsibility of the home, the church, the community and the school. The Board is primarily concerned with the intellectual growth of the student, so that he or she can gain and use knowledge to communicate, think critically, understand the scientific-technological age, appreciate native and human relationships and take responsibility for being a good citizen.

Meadow Lake Office  
606 5<sup>th</sup> Avenue West  
Meadow Lake S9X 1A9  
Ph 236.5614  
Fx 236.3922

Turtleford Office  
Box 280  
Turtleford SOM 2Y0  
Ph 845.2150  
Fx 845.3392

Lloydminster Office  
5411-50<sup>th</sup> Avenue  
Lloydminster S9V OR1  
Ph 825.2828  
Fx 825.3991

Director of Education	Glen Winkler	236.5614
Superintendent Curriculum and Instruction	Brian Gislason	236.5614
Superintendent Curriculum and Instruction	Ron Biberdorf	825.2828
Superintendent Human Resources	Dave Thompson	825.2828
Assistant Superintendent Human Resources	Cory Rideout	236.5614
Superintendent Student Services	Carolyn Forsey	236.5506
Secretary Treasurer	Greg Gerwing	236.5614
Assistant Secretary Treasurer	Vincent Gaudet	236.5614
Technology Coordinator	Kim Chiverton	236.5614
Resource-Based Learning Consultant	Lynda Erlandson	248.3602
Coordinator of Student Services	Kay Montgomery	845.2150
Supervisor of Transportation	Rick McKeil	845.2150

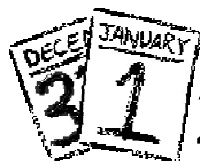

# 2009-10 School Calendar

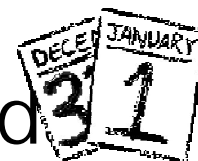

Administration Day (no classes)  
First Day of Classes (morning only)/  
Administration Day (afternoon)

Monday, August 24, 2009  
Tuesday, August 25, 2009

Labour Day (no school)  
Professional Learning Communities (no classes)  
Teachers' Convention (2 days)

Monday, September 7, 2009  
Wednesday, September 16, 2009  
Monday/Tuesday, September 28/29, 2009

Thanksgiving Day (no school)  
**Noon Dismissal**/PLC Afternoon

Monday, October 12, 2009  
Wednesday, October 21, 2009

Remembrance Day (no school)  
School Holiday  
In-Lieu of Parent/Teacher Evening Conferences (no school)  
**Noon Dismissal**/PLC Afternoon (no classes)

Wednesday, November 11, 2009  
Thursday, November 12, 2009  
Friday, November 13, 2009  
Wednesday, November 25, 2009

## **DECEMBER BREAK (10 days)**

Last Day of Classes  
School Reopens

Friday, December 18, 2009  
Monday, January 4, 2010

Professional Learning Communities (no classes)  
**WINTER BREAK (5 days)** Includes Family Day

Wednesday, February 3, 2010  
Monday-Friday, February 15-19, 2010

**Noon Dismissal**/PLC Afternoon (no classes)  
In-Lieu of Parent/Teacher Evening Conferences (no school)

Wednesday, March 10, 2010  
Friday, March 19, 2010

## **SPRING BREAK (6 days)**

Last Day of Classes  
School Reopens

Thursday, April 1, 2010  
Monday, April 12, 2010

Victoria Day

Monday, May 24, 2010

**Noon Dismissal**/Last Day of Classes  
Report Card/Administration Day

Tuesday, June 29, 2010  
Wednesday, June 30, 2010

# Student Rights and Responsibilities

1. I have a **RIGHT** to learn in this school.  
It is my **RESPONSIBILITY** to listen to instructions and to follow general classroom guidelines set by my teachers.
2. I have the **RIGHT** to hear and be heard.  
It is my **RESPONSIBILITY** not to talk, shout, or make loud noises when others are speaking.
3. I have a **RIGHT** to be respected in this school.  
It is my **RESPONSIBILITY** to respect other people in this school.
4. I have a **RIGHT** to be safe in this school.  
It is my **RESPONSIBILITY** not to threaten or physically harm anyone else.
5. I have a **RIGHT** to personal property and privacy.  
It is my **RESPONSIBILITY** to respect the personal property of others and to accept their right to privacy.

## Gateway Elementary Conduct Guidelines

1. Show pride in your school, keep it neat and clean. No sunflower seeds or gum.
2. Walk in the school building.
3. Treat each other with respect; Use your good manners at all times.
4. No foul language.
5. Balls, bats and other sports equipment are meant to be used outside.
6. The front of the school, bus lane and parking lot are out of bounds.
7. Play safe – avoid pushing, shoving, and other actions which could hurt or injure someone.
8. Students are to wait for their bus in an orderly manner.
9. Ask permission before using school equipment or supplies.
10. T-shirts must display appropriate symbols and language only.
11. Scooters, skateboards or roller blades may not be brought to school.
12. Students should only be upstairs when accompanied by a teacher.

13. Students must use their designated entrances.
14. The use of cigarettes, drugs or alcohol will be prohibited at all times, including all school activities.
15. Bicycles are to be parked and locked in the designated locations at school.

## Student Expectations

Mutual respect fosters a positive learning environment. All members of our school community, staff, students and parents must accept their part of the responsibility for creating such an environment.

From time to time certain students do not live up to the expectations or responsibilities as outlined. We all have our good and bad days; however, we always strive for positive attitudes and endeavor to discourage the negative ones.

Just as we are rewarded for acceptable behaviour, we must consider consequences for unacceptable behaviour. Depending on the nature, severity and frequency of the undesired behaviour the following consequences will be considered:

- i) withdrawal of privileges
- ii) detentions
- iii) discussion with parents
- iv) discussion with administration
- v) parent supervision in school
- vi) suspension from school for 1-7 days
- vii) meeting with the Board of Education
- viii) expulsion from school
- ix) fighting during the school day will result in automatic suspension

# School Timetable

Gateway Elementary operates on a 6 day cycle. Days are designated Day 1 thru Day 6 and do not follow the calendar days of the week.

8:30 a.m.	Doors open for students
8:55 a.m.	Morning call in bell
9:00 a.m.	Classes begin
10:19 a.m.	Morning Recess dismissal bell
10:33 a.m.	POWER MATH
10:46 a.m.	Classes resume
12:00 p.m.	Lunch
12:20 p.m.	Noon Recess dismissal bell
12:58 p.m.	D.E.A.R. Time (Drop Everything And Read)
1:13 p.m.	Classes resume
2:27 p.m.	Afternoon Recess dismissal bell
2:41 p.m.	Classes resume
3:30 p.m.	Dismissal

## Gateway Elementary School Awards

Gateway students are encouraged to set personal goals and become involved in a wide variety of activities during the school year. We grow daily in our knowledge and welcome the opportunity to share our experiences with our peers. We recognize this growth with classroom trophies for:

**Excellence in Academics**

**Overall average of 90% or higher**

**Honours in Academics**

**Overall average of 80%–89%**

**Citizenship**



**Students who take the opportunity to be responsible members of our school community.**

**Griffin Award**

**Students who show significant growth in attitude, academics and independence.**

Our most important award is our **Gateway Win-It Certificate**. Everyone at Gateway gets a Gateway Certificate. The number of Win-It stickers each student can receive is based on how active they become in our school's programs. We encourage all students to participate in as many activities as they can to get as many Win-Its as possible.

## Win-It Awards

Academic Excellence	Cross Country Running	Most Improved (Griffin Award)
Academic Honors	Curling	Newspaper Group
Accelerated Reader	Floor Hockey	Recycling
Attendance	Fundraising	Small Engines
Badminton	Gardening	Speeches
Baking	Good Effort	Speedstacking
Band	Grade 5	
Basketball	Grade 6	
Bells	Helping Hands	Spirit
Board Games	Heritage Fair	Spring Concert
Chorus		Swimming
Citizenship	House Leader	TCO <sup>2</sup> Conference
Class Rep	House League Champions	Telephone Monitor
Climbing Wall	House League Participant	Tetherball
Community Helper	Juggling	Track and Field
Composting	Knitting Club	Volleyball
Consistent Worker	Library Assistant	Winter Olympics
Crafts	Marathon	Writers' Circle
	Multimedia	

## Student Evaluation Policy

Evaluation is an integral part of the teaching-learning process. It is a planned continuous activity that reflects the intended outcomes of the curriculum. The evaluation process assists teachers in meeting individual needs and providing appropriate programs for the students. Students are given opportunities to demonstrate the extent of their knowledge, skills and abilities through assessment techniques for formative, diagnostic and summative purposes. Students are made aware of the objectives of the program and the procedures to be used in assessing performance relative to the objectives.

The student's progress will be communicated to the parents/guardians and students with a progress report a minimum of three times during the school year. Parents/guardians will be provided the opportunity to meet with the teacher at two parent-teacher interviews and more as required to discuss student progress and to enhance communication between home and school.

Students will be expected to complete all assignments to the best of their ability and hand in projects and homework on the due date. Evaluation will reflect the effort and cooperation given by each student.



## Reporting Periods

First Report	November with conferences in early autumn
Second Report	March with conferences in early spring
Third Report	Last day of school

## Parent Communication

Parents are urged to contact the child's classroom teacher at any time when a matter arises that is of concern to their child's school process. Immediate attention to these concerns results in a positive experience for the child. Please phone or write to arrange to arrange an interview.

## Resource

Students may, upon consultation with the resource teacher, the school administration, the classroom teacher and parent(s), be placed in the resource program. Individual programs are developed to assist the child with their weaknesses, to allow them to progress in the classroom.

## Student Services

Gateway Elementary School has several guidance counselors to assist students. Both students and parents are invited to contact the counselors directly to discuss student progress as well as other problems as they arise. The counselors also handle referrals to the Student Services provided by the School Division Board. More severe problems or achievement and ability tests are handled at this level.

# NWSD Bus Regulations

1. Students must be assigned a seat by the bus driver and must occupy that seat at all times.
2. Students must remain seated while on the bus.
3. Students must sit in a quiet and proper manner, with legs and arms not protruding into aisles.
4. All parts of the student's body must be kept inside the bus at all times.
5. Students' lunch containers, books and parcels must be placed on the floor near their feet or held on their lap.
6. Shouting, foul language and fooling around are not permitted on the bus.
7. Students must promptly obey all instructions from the driver.
8. Visiting students must ask for permission from the bus driver before boarding the bus.
9. Windows may be adjusted only with permission of the bus driver.
10. Sunflower seeds are prohibited on all school buses.

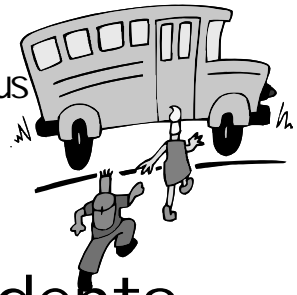

## Loading and Unloading Students

Students must be dropped off or picked up in front of Gateway Elementary School as you travel WEST so that students do not have to cross the street. Due to high traffic flows and safety concerns, the STAFF PARKING LOT IS NOT TO BE USED FOR STUDENT DROP OFF OR PICK UP. The bus lane, which is on the EAST side of the school, is NOT to be used for student pick up or drop off.

## Morning, Recess and Noon Procedures

Students will go outside for recess, noon and before school in the morning unless it is a designated "In Day". Upon morning arrival, students will place their bags in their homeroom or at their locker and then go outside.

## Lunch Hour

Town of Meadow Lake students are permitted to eat lunch at school. Inappropriate behavior will result in students NOT being allowed to eat their lunch at school. Students may go home for lunch. GATEWAY STUDENTS ARE NOT ALLOWED TO EAT LUNCH AT MEADOW LAKE RESTAURANTS AND/OR STORES UNLESS PICKED UP AND ACCOMPANIED BY THEIR OWN PARENT OR GUARDIAN.

Our school operates a noon hour lunch booth offering a daily lunch menu item, as well as healthy snacks, fruits, yogurt and beverages meant to supplement lunch sent from home.

We also offer a Milk Program where students can pre-purchase milk delivered to their home room at lunch time.

## Intramural House System

Staff and students all belong to one of the four houses: LYNX, COUGARS, OSPREY, and HAWKS. Academics, athletic activities and participation are the source of accumulated points to determine the winning house at the year's end. House games are played at noon.

Each student is given a house pinnie at the beginning of the year. Lost house pinnies are the responsibility of students. Replacement cost is \$8.00.

## Lockers

Students are provided with locker space for their belongings. Locks are provided for these lockers by the school. Only school locks are permitted on the lockers. Lost locks will be the responsibility of the students. Replacement cost is \$5.00.

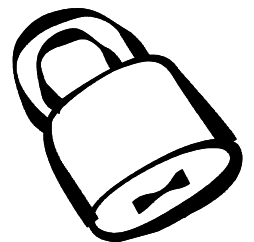

Unannounced locker inspections will be carried out throughout the school year for health, safety, neatness and other reasons.

# Band Fees

There are set fees for Grade 6 students enrolled in Band as follows:

\$65 Single child enrolled in Band Program

\$100 Family (two or more students enrolled in Band at any Meadow Lake school)

# Agenda Books

Organization is the key to success! To aid in the development of great organizational skills, our school requires that each student purchase a school day planner (\$5). By using the day planner every day in class to record assignments and upcoming information it becomes a tool for communication between home and school. Our expectation is that your child brings his/her day planner home each evening and returns it to school each morning. Feel free to write comments, questions or suggestions in the day planner. Please initial it after you have checked that all necessary assignments are completed.

# Other Expenses

As part of our Physical Education program, students participate in swimming lessons at the Meadow Lake Aquatic Centre. We ask that students contribute \$10 towards the cost of these lessons.

In June, each grade plans a group activity to celebrate the end of a successful year! The cost to students ranges from \$15-\$20, depending on the venue selected.

From time to time, students may participate in class field trips (i.e. swimming, bowling, curling). For these events students will be charged a nominal \$2 fee.

# Attendance

Students are required to be in regular attendance and on time for all classes. It may be necessary for students to be absent from school in cases of illness, family matters or various events. If the student is to be absent, the parent or guardian is expected to phone the school with an explanation of the absence or send a signed note with the student giving necessary information.

On that rare occasion that your child must leave the school during regular school hours, please notify the school with a phone call or a written note.

# Lates

Prompt, regular attendance is expected of all students. Those who arrive late in the morning or at noon must get a late slip from the office before being admitted to the classroom.

# School Pictures

Pictures are taken in September or October. Our practice has been to take individual pictures yearly. Purchase of pictures is optional. All students are requested to have pictures taken so that prints are available for school records.

# Student Telephone

Students need their homeroom teacher's permission to use the phone. The student phone will be used only for urgent business and emergencies. Lunch and/or after school plans should be made with parents before students arrive in the morning



# Gateway Elementary Parent Council

The Parent Council meets every month. Parent reps for each classroom will be selected in the fall. If you are interested in volunteering on the council, please contact your homeroom teacher.

# Parental Involvement

During the year it is sometimes necessary to ask for parental help in activities such as field trips, classroom work, track and field, library, fundraising, etc. The school requests that parents provide a current telephone number and address. The school sincerely appreciates and welcomes parents' involvement. Individuals who volunteer and who work individually with students must sign a Confidential Disclosure.

# Visitors to Gateway

Parents/guardians are always welcome at school. We ask that you stop by the office so that we may assist you in locating the student or teacher you wish to contact. School supervision is provided by the teachers for our students and we are not expected to supervise students from other schools. It is also expected that our students not visit other schools unless first contacting the administration of that school.

# Christmas Gifts

To avoid pressure on parents, especially those with a large number of children in school, exchanging of gifts as a classroom group is not allowed.

If students are exchanging gifts, we encourage that it be done away from school.



# Communicable Diseases

If a child is recovering from an illness, and the parent feels it necessary for him/her to remain indoors, a note is required.

Head lice are common among school-age children from time to time. Public health instructs us to send children home who have head lice while at school. Children are to remain at home until treatment is successful. When a child has head lice at school, every student in that child's room will receive a note regarding treatment and symptoms. Parents are encouraged to periodically check their child's hair. Lice are spread by direct head to head contact or by sharing personal items such as brushes and hats. Lice do not jump, hop or fly.

# Health

Parents should notify the school if their child has any health problems, such as allergies, diabetes, and epilepsy, which may affect school progress and his/her participation in school activities. The teacher should be aware of any special care your child may need regarding his/her health. Please inform the bus driver of these circumstances as well.

Teachers are not permitted to administer medication to students. This includes aspirin or Tylenol for headaches. Parents should consult their doctor as to the best times to administer medication.

# Illness at School

If a child becomes ill at school, it is sometimes necessary that he/she return home. Please supply the school with an alternate number to call in the event that the parent is not at home.

# Accidents at School

In the case of an accident requiring the attention of a doctor, we attempt to contact parents. However, if parents are not available and the accident appears quite serious we do take the child to the clinic or hospital for treatment and notify the parents as soon as possible. School staff will not sign for treatment by a doctor.

# Gateway Elementary

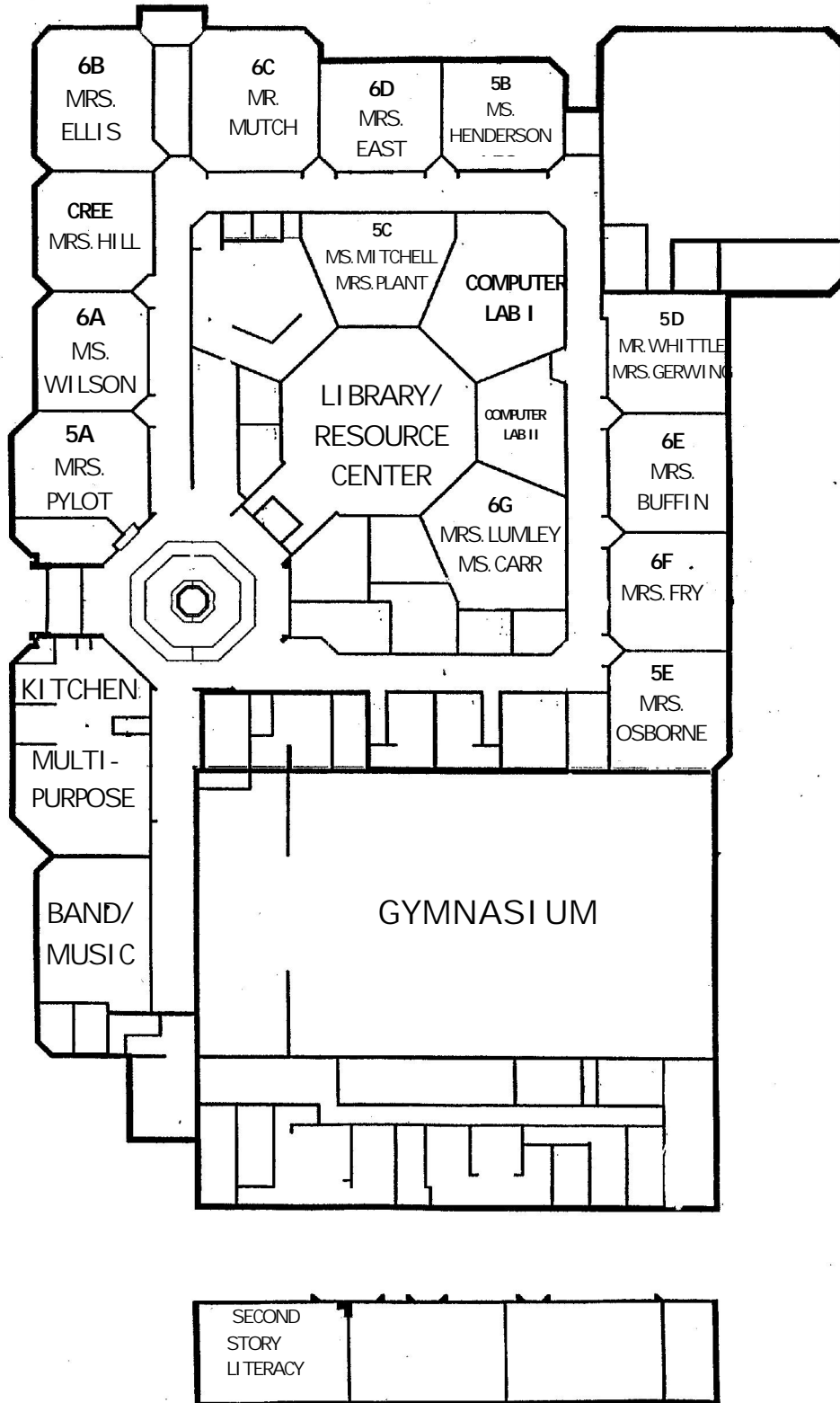

# Gateway Elementary Student Timetable

Period	Time	Day1	Day 2	Day 3	Day 4	Day 5	Day 6
	9:00-9:05	Homeroom					
1	9:05-9:42						
2	9:42-10:19						
	10:19-10:33	Morning Recess					
	10:33-10:46	POWER MATH					
3	10:46-11:23						
4	11:23-12:00						
	12:00-12:20	Lunch					
	12:20-12:58	Noon Recess					
	12:58-1:13	D.E.A.R. Time					
5	1:13-1:50						
6	1:50-2:27						
	2:27-2:41	Afternoon Recess					
7	2:41-3:18						
	3:18-3:30	Homeroom					

